

W09 SPECIFICATIONS

Adapters, teeth and accessories

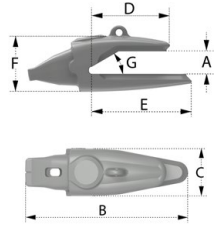

BE

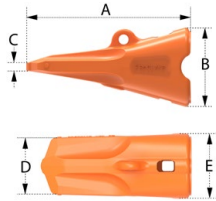

GPE









ML-lock



Typical machine weight - Excavator
Maximum breakout force in HD/XHD

25-35 MT
168 kN

Type	Part. no			Weight lb	Lip thickness inch	A inch	B inch	C inch	D inch	E inch	F inch	Lip bevel angle°
BE	709010			32,6	1,57	1,65	14,96	4,37	5,16	8,94	5,24	30
BE	709011			32,4	1,97	2,05	14,96	4,37	5,16	8,94	5,24	30
GPE	709100			19,6		11,26	5,55	0,55	4,06	5		
ML-lock*	709302			0,9		4,8						

* Use a 0,394 inch socket wrench to mount and dismount the mechanical lock 709302.

W10 SPECIFICATIONS

Adapters, teeth and accessories

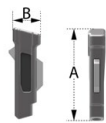
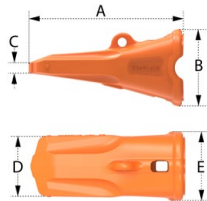
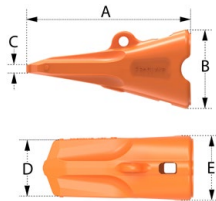
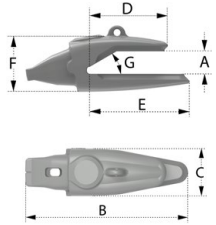

Typical machine weight - Excavator
Maximum breakout force in HD/XHD

35-50 MT
232 kN

Type	Part. no			Weight lb	Lip thickness inch	A inch	B inch	C inch	D inch	E inch	F inch	Lip bevel angle°
BE	710010			55,7	2,3	2,05	18,03	5,21	7,26	11,04	6,23	30
BE	710011			53,7	2,76	2,44	18,03	5,21	7,26	11,04	6,23	30
GPE	710100			28,4		12,8	6,04	0,59	4,73	5,05		
AE	710110			33,2		13,17	6,04	0,75	5,09	5,29		
SL-lock	710301			0,9		4,89	1,5					
ML-lock*	710302			1,1		4,81	1,5					
T-tool	700700			3,3								

* Use a 0,433 inch socket wrench to mount and dismount the mechanical lock 710302.

W20 SPECIFICATIONS

Adapters, teeth and accessories

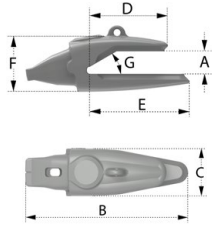

BE

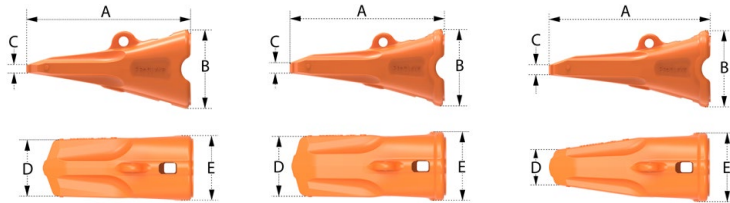

GPE

AE

PE

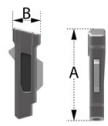

SL-lock

ML-lock

T-tool



Typical machine weight - Excavator 40-60 MT
Maximum breakout force in HD/XHD 326 kN
Typical machine weight - Face shovel 40-80 MT
Maximum breakout force in HD/XHD 408 kN

Type	Part. no			Weight lb	Lip thickness inch	A inch	B inch	C inch	D inch	E inch	F inch	Lip bevel angle°
BE	720010			90,7	2,76	2,84	21,46	6,18	8,94	12,95	7,32	30
BE	720011			92,7	2,36	2,44	21,46	6,18	8,94	12,95	7,32	30
GPE	720100			47,1		14,8	7,44	0,71	5,47	6,65		
AE	720110			55,1		15,24	7,44	1,02	5,83	6,65		
PE	720120			51,1		15,91	7,44	0,99	3,42	6,65		
SL-lock	720301			2,2		5,73	1,99					
ML-lock*	720302			1,8		5,73						
T-tool	700700			3,3								

* Use a 0,512 inch socket wrench to mount and dismount the mechanical lock 720302.

W25 SPECIFICATIONS

Adapters, teeth and accessories

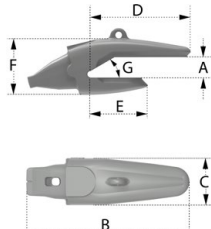
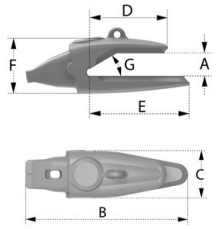

BE

TL

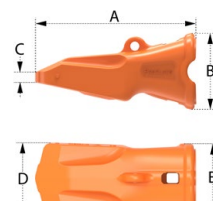
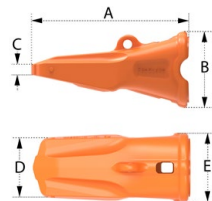
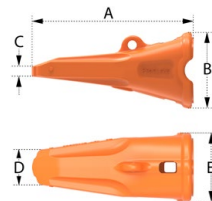
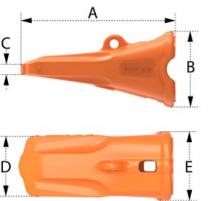
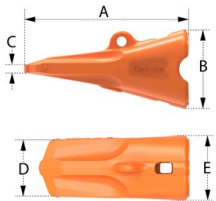

GPE

AE

PE

AL

XAL

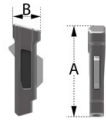

SL-lock

ML-lock

T-tool



Typical machine weight - Excavator
Maximum breakout force in HD/XHD
Typical machine weight - Face shovel
Maximum breakout force in HD/XHD
Typical machine weight - Loader
Maximum breakout force in HD/XHD

50-70 MT
412 kN
50-100 MT
515 kN
50-100 MT
736 kN

Type	Part. no			Weight lb	Lip thickness inch	A inch	B inch	C inch	D inch	E inch	F inch	Lip bevel angle°
BE	725010			127,7	3,15	3,23	23,82	6,95	8,03	14,45	8,07	30
BE	725011			125,6	2,76	2,84	23,82	6,95	11,38	14,45	8,15	30
TL	825026			133,3	2,95	3,03	24,37	6,95	14,92	8,5	8,42	30
GPE	725100			61,7		16,26	7,91	0,77	6,18	7,09		
AE	725110			73,8		16,77	8,39	1,11	6,61	7,56		
PE	725120			69,4		17,52	8,39	1,09	3,9	7,56		
AL	825110			85,9		17,09	8,39	1,11	6,58	7,56		
XAL	700700			106,8		17,44	8,39	1,1	7,76	7,56		
SL-lock	725301			2,6		6,31	2,26					
ML-lock*	725302			2,2		6,31						
T-tool	700700			3,3								

* Use a 0,512 inch socket wrench to mount and dismount the mechanical lock 725302.

W30 SPECIFICATIONS

Adapters, teeth and accessories

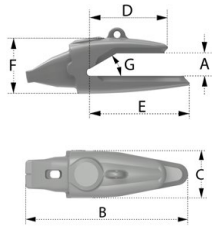

BE

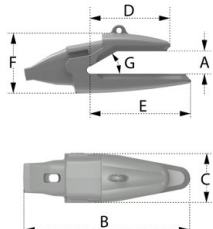

BME

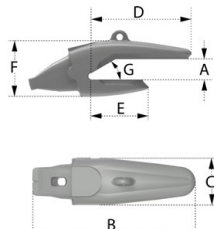

TL

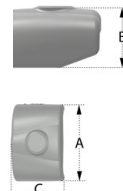

CM

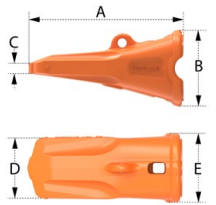

AE

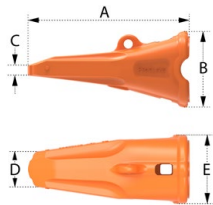

PE

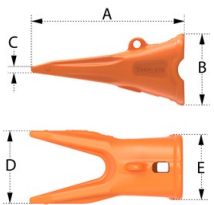

WE

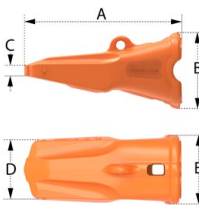

AL

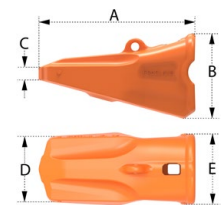

HAL

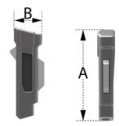

SL-lock



ML-lock

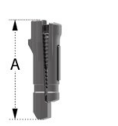

SML-lock



T-tool



Typical machine weight - Excavator
Maximum breakout force in HD/XHD
Typical machine weight - Face shovel
Maximum breakout force in HD/XHD
Typical machine weight - Loader
Maximum breakout force in HD/XHD

70-120 MT
506 kN
100-120 MT
633 kN
100-205 MT
904 kN

Type	Part. no			Weight lb	Lip thickness inch	A inch	B inch	C inch	D inch	E inch	F inch	Lip bevel angle°
BE	730010			188,8	3,54	3,62	26,69	7,95	12,48	16,06	9,57	30
BME	730012			174	3,54	3,62	26,69	7,95	12,48	16,06	9,37	30
TL	830024			200,4	2,95	3,03	27,37	7,95	16,54	9,61	9,8	30
TL	830026			200,4	3,54	3,62	27,37	7,95	16,54	9,61	9,92	30
CM	730501			16,7		8,39	3,46	5,59				
AE	730110			104,2		18,46	9,29	1,2	7,48	8,46		
PE	730120			100,2		18,94	9,29	1,18	4,53	8,46		
WE	730125			90,3		19,88	9,29	0,79	9,45	8,46		
AL	830110			120		18,82	9,29	1,2	7,4	8,46		
HAL	830112			159,06		18,82	10,16	1,46	7,87	8,46		
SL-lock	730301			3,2		7,05	2,68					
SML-lock*	730312			3,1		7,09						
ML-lock*	730302			3,1		7,09						
T-tool	700700			2,64								

* Use a 0,669 inch socket wrench to mount and dismount the mechanical lock 730302.

W40 SPECIFICATIONS

Adapters, teeth and accessories

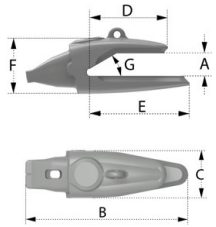

BE

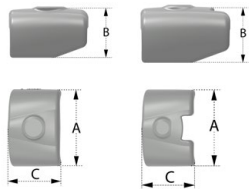

CM, CCM

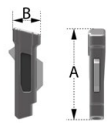

SL-lock

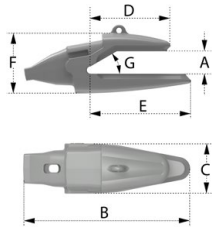

BME

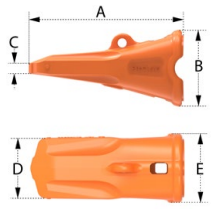

AE



ML-lock

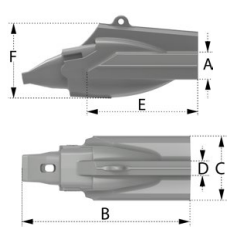

CCE

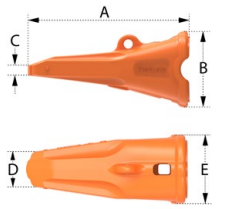

PE



T-tool

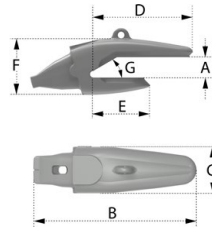

TL

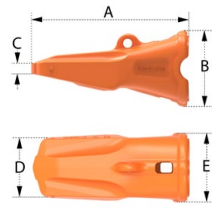

AL

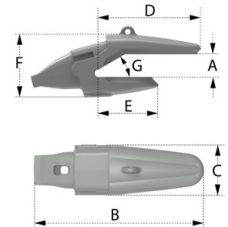

MTL

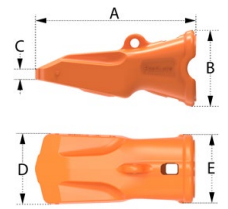

XAL

Typical machine weight - Excavator
Maximum breakout force in HD/XHD
Typical machine weight - Face shovel
Maximum breakout force in HD/XHD
Typical machine weight - Loader
Maximum breakout force in HD/XHD

120-200 MT
623 kN
120-300 MT
779 kN
>205 MT
1113 kN

Type	Part. no			Weight lb	Lip thickness inch	A inch	B inch	C inch	D inch	E inch	F inch	Lip bevel angle°
BE	740010			268,7	3,94	4,02	29,92	8,9	14,33	17,99	10,79	30
BME	740012			251,1	3,94	4,02	29,92	8,9	14,33	17,99	10,79	30
BE	740014			321,6	4,73	4,85	32,11	8,9	15,51	19,64	11,6	30
BME	740015			301,7	4,73	4,85	32,11	8,9	15,51	19,64	11,6	30
CCE	740080			648,3	3,94 - 4,72	4,72	33,35	12,6	2,76	20,87	14,09	
TL	840026			279,7	3,94	4,06	30,47	8,9	18,23	10,75	11,06	30
MTL	840027			268,7	3,94	4,06	30,47	8,9	18,23	10,75	11,1	30
CM	740501			28,4		9,37	3,94	6,34				
CCM	740502			23,3		9,37	3,94	6,34	7,4	8,46		
AE	740110			141,3		20,51	10,32	1,33	8,27	9,37		
PE	740120			131,1		21,02	10,32	1,3	5,08	9,37		
AL	840110			163		20,91	10,32	1,34	8,19	9,37		
XAL	840111			191,4		21,38	10,32	1,34	7,91	9,37		
SL-lock*	740301			4,4		7,89	2,97					
ML-lock*	740302			5,1		7,89						
T-tool	700700			3,3								

* Use a 0,748 inch socket wrench to mount and dismount the mechanical lock 740302.

W50 SPECIFICATIONS

Adapters, teeth and accessories

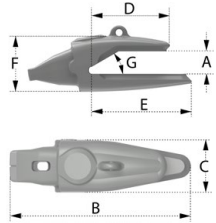

BE 

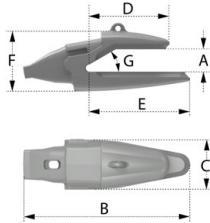

BME 

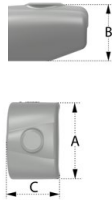

CM 

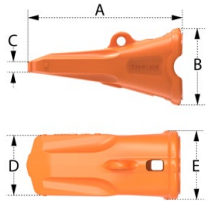







AE 



ML-lock



Typical machine weight - Excavator 180-250 MT
 Maximum breakout force in HD/XHD 761 kN
 Typical machine weight - Face shovel 180-360 MT
 Maximum breakout force in HD/XHD 951 kN

Type	Part. no			Weight lb	Lip thickness inch	A inch	B inch	C inch	D inch	E inch	F inch	Lip bevel angle°
BE	750010			375,1	4,72	4,84	32,72	9,76	15,51	16,61	11,85	30
BME	750012			350,9	4,72	4,84	32,72	9,76	15,51	19,61	11,85	30
CM	750501			36,3		10,28	4,33	7,13				
AE	750110			189,2		22,44	11,3	1,46	9,09	10,32		
ML-lock*	750302			6,6		8,66						

* Use a 0,748 inch socket wrench to mount and dismount the mechanical lock 750302.



EXCAVATOR

Adapters and teeth

ADAPTER

BE

Standard bottom leg adapter. Low profile design, improved flow of material in and out of bucket.

BME

Bottom leg adapter with a mechanical wear cap. The top of the adapter is well protected against excess wear.

CCE

Casted corner adapter with mechanical wear cap. The welded adapter is designed to withstand the toughest conditions.

WEAR CAP

CM

Mechanical wear cap protects the adapter top side in high abrasion and impact applications.

CCM

Mechanical wear cap to be used together with the casted corner adapter

TOOTH

AE

Abrasion tooth for highly abrasive soils and rocks such as granite, basalt and sandstone. The design provides maximal wear material with maintained good penetration.

PE

Penetration tooth with added body mass and narrow tip combines penetration with impact and abrasion resistance.

GPE

Standard tooth with slim design for optimal penetration and durability in general purpose applications.

WE

Penetration tooth for hard surface layers and compact terrain.

LOCK

SL

Standard lock provides easy and secure tooth replacement. The vulcanized rubber core provides a strong and tight fit.

ML

Mechanical lock for safer mounting and dismounting procedure

SML

Mechanical reusable lock for work in hot slag applications with safer mounting and dismounting

TOOL

T

Tool for mounting and dismounting the locking device. Simplifies the change of teeth and is recommended for safety reasons.



LOADER

Adapters and teeth

ADAPTER

TL

Standard top leg adapter. Low profile design, improved flow of material in and out of bucket.

MTL

Top leg adapter with a mechanical wear cap. The top of the adapter is well protected against excess wear.

WEAR CAP

CM

Mechanical wear cap protects the adapter top side in high abrasion and impact application.

LOCK

SL

Standard lock provides easy and secure tooth replacement. The vulcanized rubber core provides a strong and tight fit.

ML

Mechanical lock for safer mounting and dismounting procedure.

SML

Mechanical reusable lock for work in hot slag applications with safer mounting and dismounting.

TOOTH

AL

Standard tooth which offers good penetration. Optimal in both general and highly abrasive environments.

XAL

Abrasion tooth for highly abrasive soils and rocks such as granite, basalt and sandstone. The design provides maximal wear material with maintained good penetration.

HAL

Abrasion tooth with maximized wear material in the tip. The design provides additional wear material with maintained good penetration.

TOOL

T

Tool for mounting and dismounting the locking device. Simplifies the change of teeth and is recommended for safety reasons.

SHROUDS

Excavator and loader

LIP SHROUD

MSC	MSL	MSR	MSP
Mechanical lip shroud Center for straight edges and for use in combination with MSL & MSR on spade nose buckets. Provides full lip protection between adapters in abrasive applications.	Mechanical lip shroud Left* 15° angle for delta and spade nose buckets. * Left from excavating direction.	Mechanical lip shroud Right* 15° angle for delta and spade nose buckets. * Right from excavating direction.	Mechanical shroud protector designed to protect the lock- ing device and the backside of the shrouds.

RAIL	LOCKING PARTS	SIDE SHROUD	PIN AND RING
WSR Welded on shroud rail holds the lip shrouds in secure position.	Shroud Lock, Bolt and Washer Self tightening lock, bolt and washer for the mechanical shroud.	SSM Mechanical side shroud is used to protect the bucket side plates and fastened with pin and ring.	PIN AND RING Locking pin and ring for the side shroud.

HEEL SHROUD

WHS
Welded on heel shroud provi- des excellent wear protection of the lower outside corner of all types of buckets.

APPLICATION TABLE

APPLICATION TABLE Based on DIN 18300 ground classification			
Ground classification	Description of ground conditions	Working conditions	Application
Class 1 Top soil without stones	Top layer of soil.	Very little wear. Very little penetration resistance. No impact resistance.	GP
Class 2 Wet ground	Sludge, mud, peat.	Little wear. Very little penetration resistance. No impact resistance.	GP
Class 3 Light ground	Sand, fine gravel, sandy soil. Stone size up to approx. 2,4 inch.	Moderate wear. Little penetration resistance. No impact resistance.	GP
Class 4 Moderately heavy ground	Very stony ground, gravel, stones. Stone size above 2,4 inch.	Considerable wear. Some penetration resistance. Moderate impact resistance.	GP / HD
Class 5 Dense, moderately heavy ground	Till, rigid clay, sand-clay mix, moraine, marl.	Considerable wear. Moderate penetration resistance. Little impact, some break through resistance.	HD
Class 6 Dense, heavy ground	Hard marl and clay, hard sandy ground, hard stony soil. Stone size up to approx. 7,9 inch.	Considerable wear. Considerable penetration resistance. Considerable impact and break through resistance.	HD
Class 7 Lighter rock	Loose rock, crumbled rock, slate. Very hard ground with stones, approx. 7,9 inch or bigger.	Usually considerable wear. Considerable penetration resistance. Considerable impact and break through resistance.	XHD
Class 8 Heavy rock	Blasted rock, size over 3,5 ft3.	Very significant wear. Considerable penetration resistance. Very significant impact and break through resistance.	XHD

For further information on welding, assembly and maintenance, see welding and assembly instructions.

Breakout force diagram – Backhoe

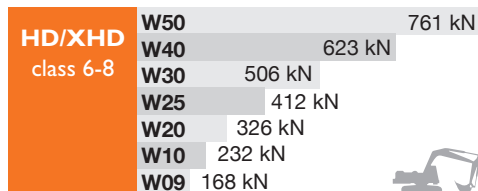

Breakout force diagram – Face shovel

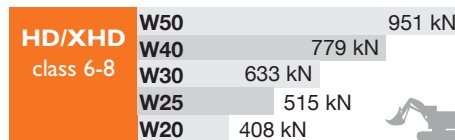

Breakout force diagram

